

ADDITIONAL INFORMATION

EASEMENT

STATE OF NEW HAMPSHIRE

TO

SPRINT-NEXTEL, COMMUNICATION EASEMENT

FIBER-OPTIC FACILITY

MANCHESTER

HILLSBOROUGH COUNTY REGISTRY

AUBURN, CANDIA, RAYMOND, EPPING, NEWFIELDS,

NEWMARKET

ROCKINGHAM COUNTY REGISTRY

Sprint Nextel Contacts

Paul Schumaker
(603) 219-6087

Mike Hanifan
(413) 237-2598

Always call Dig-Safe first. 1-888-344-7233

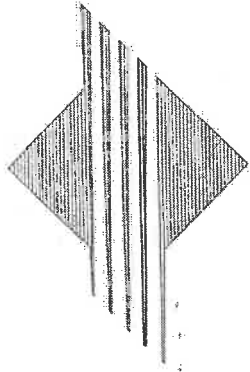

US Sprint

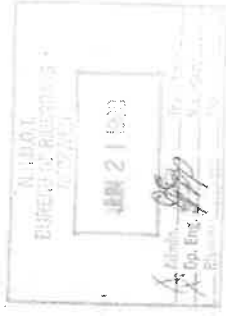

A S - B U I L T

WORCESTER, MA TO PORTLAND, ME

ROUTE 880 - PROJECT 122-002

REVISION	DESCRIPTION

AS-BUILT NOTE:
 SPECIALLY PLOTTED AT 42" DEPTH.
 ALL 4" CONDUITS ARE 1 1/4" THROUGHT.

MANCHESTER, N.H.

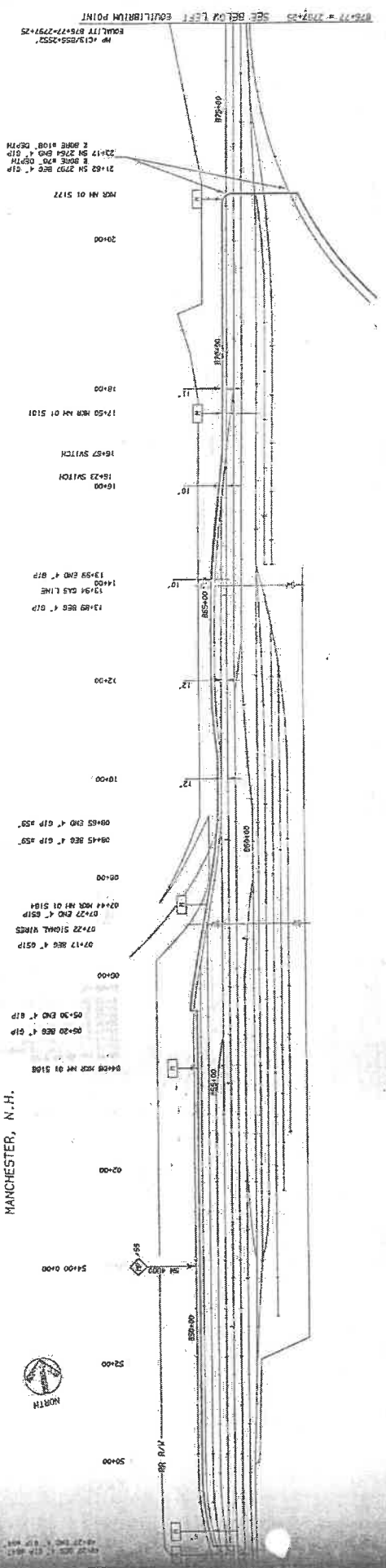

21+62 5N 270' BEC 4" GIP
 23+17 5N 206' BEC 4" GIP
 2 BORE #108 DEPTH
 2 BORE #108 DEPTH

17+50 NBR NH 01 5177

20+00

18+00

17+50 NBR NH 01 5177

16+57 SWITCH

15+23 SWITCH

16+00

13+59 BEC 4" GIP

13+59 BEC 4" GIP

13+59 BEC 4" GIP

12+30

10+00

09+45 BEC 4" GIP #59

09+45 BEC 4" GIP #59

08+00

07+22 SIGNAL WIRDS

07+17 BEC 4" GIP

07+22 SIGNAL WIRDS

07+22 BEC 4" GIP

07+22 BEC 4" GIP

05+20 BEC 4" GIP

05+20 BEC 4" GIP

05+20 BEC 4" GIP

04+08 NBR NH 01 5188

02+00

51+00 0+00

52+00

50+00

51+00 0+00

52+00

50+00

51+00 0+00

52+00

50+00

51+00 0+00

52+00

50+00

51+00 0+00

52+00

50+00

CALL BEFORE YOU DIG
 MASS DIG SAFE
 MASSACHUSETTS 1 (800) 322-4844
 SURROUNDING AREA 1 (800) 225-4877
 OUT OF STATE 1 (800) 220-3770

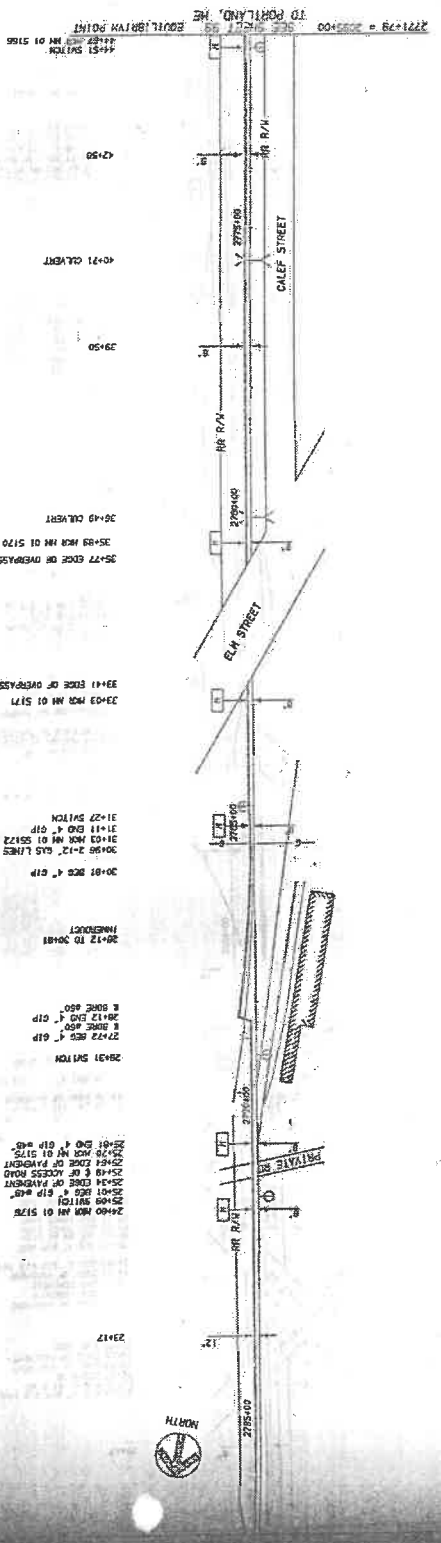

44+51 SWITCH
 44+51 SWITCH NH 01 5188

42+50

40+21 GILBERT

39+50

35+49 GILBERT

35+27 EDGE OR OVERPASS

35+27 EDGE OR OVERPASS

33+41 EDGE OR OVERPASS

33+41 EDGE OR OVERPASS

31+27 SWITCH

31+12 BEC 4" GIP

31+03 NBR NH 01 5172

30+56 2-1/2" GAS LINES

30+56 2-1/2" GAS LINES

30+56 BEC 4" GIP

30+12 TO 30+61

29+12 TO 30+61

29+12 TO 30+61

29+12 TO 30+61

29+12 TO 30+61

29+12 TO 30+61

29+12 TO 30+61

29+12 TO 30+61

29+12 TO 30+61

29+12 TO 30+61

29+12 TO 30+61

29+12 TO 30+61

29+12 TO 30+61

29+12 TO 30+61

29+12 TO 30+61

29+12 TO 30+61

29+12 TO 30+61

29+12 TO 30+61

29+12 TO 30+61

29+12 TO 30+61

29+12 TO 30+61

US Sprint
FIBER OPTICS
RECORD DRAWING
 WORCESTER, MA - PORTLAND, ME
 845+000 - 2095+000
 NETWK000-B80-B80

H. V. WOOD	1/6/97
B. BANKS	04-13-97
H. MARKIN	1/6/97
J. GILLESPIE	04-14-97

DATE: 01/11/97
 SCALE: 1"=100'
 DRAWN BY: J. GILLESPIE
 CHECKED BY: J. GILLESPIE

PROPRIETARY INFORMATION
 NOT TO BE REPRODUCED OR REPRODUCED

44-27 000 1 01 00 00
 44-27 000 1 01 00 00

REVISIONS
 DATE DESCRIPTION
 01-06-87
 04-13-87
 12-05-88
 01-14-89

CALL BEFORE YOU DIG
 NEW HAMPSHIRE & MAINE 016 SAFE
 NH & MAINE 1 (800) 225-4977
 SURROUNDING AREA 1 (800) 322-4844
 OUT OF STATE 1 (800) 220-2770

US Sprint
 FIBER OPTICS
 RECORD DRAWING
 WORCESTER, MA - PORTLAND, ME
 20954400 - 2045400
 0232 NETWORK00-BB0-BB0
 SHEET 99 OF 100
 SCALE 1"=100'
 DRAWN BY: J. WILSON
 CHECKED BY: J. WILSON
 DATE: 01-06-87

PROPRIETARY
 INFORMATION
 NOT FOR DISCLOSURE
 OR REPRODUCTION

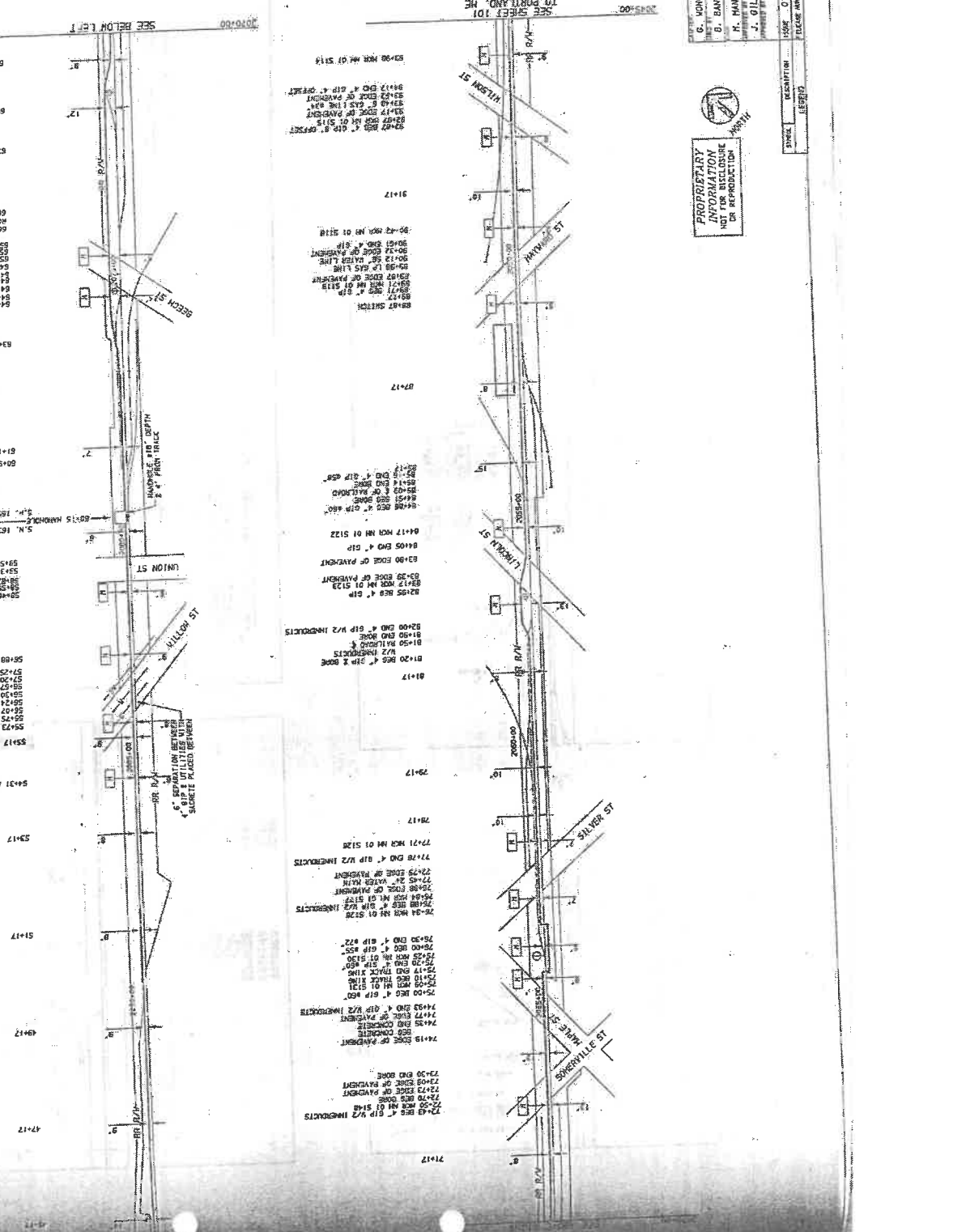

AS-BUILT NOTE:
 GENERALLY PLOTTED AT 47' DEPTH.
 ALL 4" CIRCUIT HAS A 1/4" THICKNESS.

NO.	DESCRIPTION	DATE	BY

AS-BUILT NOTES
 GENERAL FIELD NOTES
 ALL 4' CORNER HAS A 1/4" MARKER.

EAST MANCHESTER, NH

- REEL #107145800
- REEL #107145810
- 100+00 100+20 END 4" GIP # 52-10'
- 100+00 100+10 END BONE
- 99+88 4" RR SW/RT
- 99+75 5" RR SW/RT
- 99+62 4" RR SW/RT
- 99+49 4" RR SW/RT
- 99+36 4" RR SW/RT
- 99+23 4" RR SW/RT
- 99+10 4" RR SW/RT
- 98+97 4" RR SW/RT
- 98+84 4" RR SW/RT
- 98+71 4" RR SW/RT
- 98+58 4" RR SW/RT
- 98+45 4" RR SW/RT
- 98+32 4" RR SW/RT
- 98+19 4" RR SW/RT
- 98+06 4" RR SW/RT
- 97+93 4" RR SW/RT
- 97+80 4" RR SW/RT
- 97+67 4" RR SW/RT
- 97+54 4" RR SW/RT
- 97+41 4" RR SW/RT
- 97+28 4" RR SW/RT
- 97+15 4" RR SW/RT
- 97+02 4" RR SW/RT
- 96+89 4" RR SW/RT
- 96+76 4" RR SW/RT
- 96+63 4" RR SW/RT
- 96+50 4" RR SW/RT
- 96+37 4" RR SW/RT
- 96+24 4" RR SW/RT
- 96+11 4" RR SW/RT
- 95+98 4" RR SW/RT
- 95+85 4" RR SW/RT
- 95+72 4" RR SW/RT
- 95+59 4" RR SW/RT
- 95+46 4" RR SW/RT
- 95+33 4" RR SW/RT
- 95+20 4" RR SW/RT
- 95+07 4" RR SW/RT
- 94+94 4" RR SW/RT
- 94+81 4" RR SW/RT
- 94+68 4" RR SW/RT
- 94+55 4" RR SW/RT
- 94+42 4" RR SW/RT
- 94+29 4" RR SW/RT
- 94+16 4" RR SW/RT
- 94+03 4" RR SW/RT
- 93+90 4" RR SW/RT
- 93+77 4" RR SW/RT
- 93+64 4" RR SW/RT
- 93+51 4" RR SW/RT
- 93+38 4" RR SW/RT
- 93+25 4" RR SW/RT
- 93+12 4" RR SW/RT
- 92+99 4" RR SW/RT
- 92+86 4" RR SW/RT
- 92+73 4" RR SW/RT
- 92+60 4" RR SW/RT
- 92+47 4" RR SW/RT
- 92+34 4" RR SW/RT
- 92+21 4" RR SW/RT
- 92+08 4" RR SW/RT
- 91+95 4" RR SW/RT
- 91+82 4" RR SW/RT
- 91+69 4" RR SW/RT
- 91+56 4" RR SW/RT
- 91+43 4" RR SW/RT
- 91+30 4" RR SW/RT
- 91+17 4" RR SW/RT
- 91+04 4" RR SW/RT
- 90+91 4" RR SW/RT
- 90+78 4" RR SW/RT
- 90+65 4" RR SW/RT
- 90+52 4" RR SW/RT
- 90+39 4" RR SW/RT
- 90+26 4" RR SW/RT
- 90+13 4" RR SW/RT
- 90+00 4" RR SW/RT

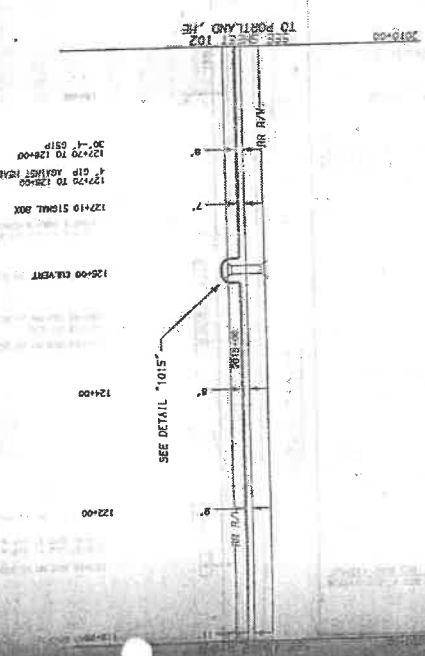
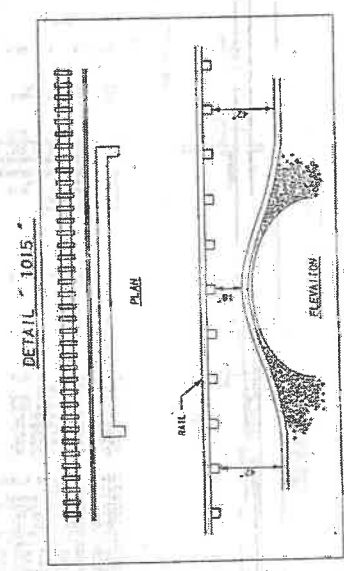
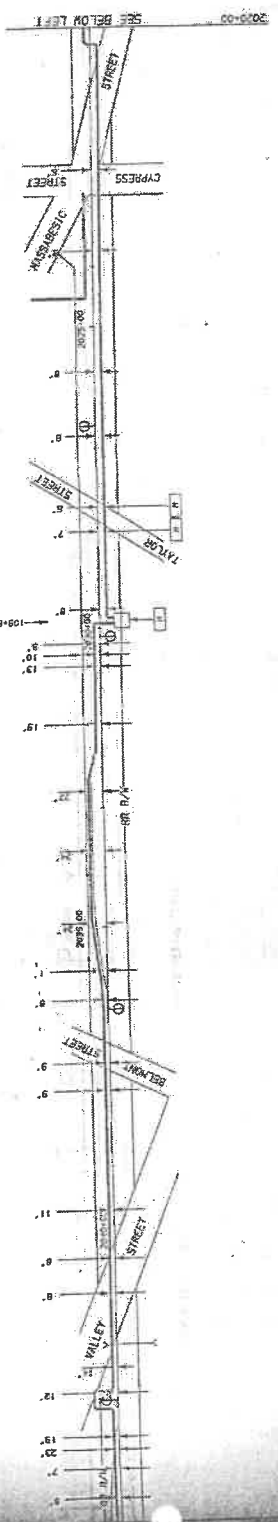

CALL BEFORE YOU DIG
 NEW HAMPSHIRE & MAINE DIG SAFE
 NH & MAINE 1 (800) 225-4577
 SURROUNDING AREA 1 (800) 322-4844
 OUT OF STATE 1 (800) 220-2770

Us Sprint
 FIBER OPTICS
 RECORD DRAWING
 NORCHESTER, MA - PORTLAND, ME
 2045-00 - 2016-00

DATE	BY	SCALE
01/07/97	A. W. WOOD	1" = 100'
04-13-97	B. BANKS	AS SHOWN
01/07/97	H. HANSEN	AS SHOWN
04-14-97	J. GILLESPIE	AS SHOWN

PROJECT NO. 2045-00
 SHEET NO. 003
 TOTAL SHEETS 003



REVISIONS
 description

AS-BUILT AND PIP.
 GENERALLY PLACED AT 42" DEPTH.
 ALL 4" CONDUIT HAS A 1/4" INVERT.

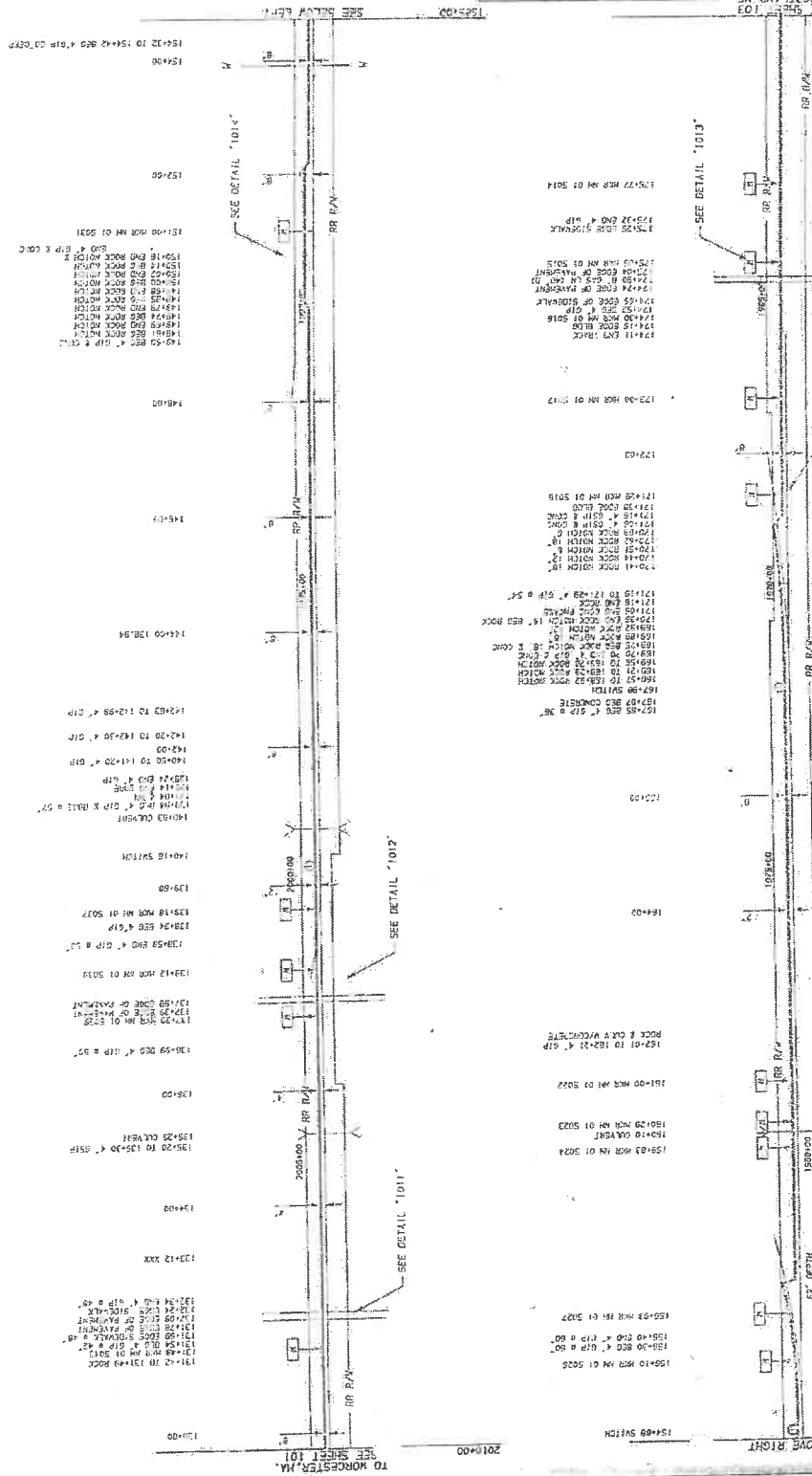

DETAIL '1014'

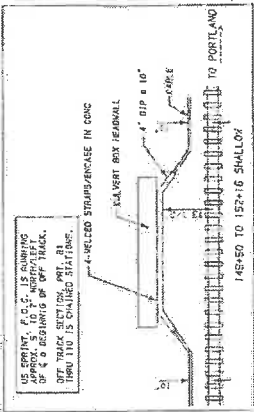

CALL BEFORE YOU DIG
 NEW HAMPSHIRE & MAINE DIG SAFE
 NH & MAINE 1 (800) 225-4577
 SURROUNDING AREA 1 (800) 322-4614
 OUT OF STATE 1 (800) 220-2770

US Sprint
 FIBER OPTICS
 RECORD DRAWING
 WORCESTER, MA - PORTLAND, ME
 2010-00 - 11900-00
 SHEET 02 OF 03

DATE	BY	CHK'D BY
04-13-97	BLANKS	SCOTT
10-2-98	HANKIN	SCOTT
04-14-97	J. GILLESPIE	SCOTT

SCALE: 1" = 40'

PROPRIETARY INFORMATION
 NOT TO BE DISCLOSED
 OR REPRODUCED

NORTH

DETAIL '1013'

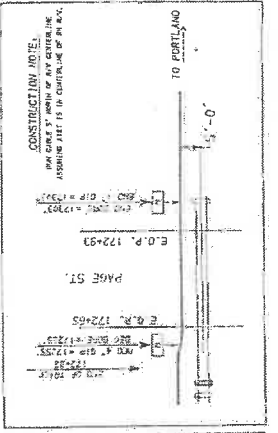

DETAIL '1012'

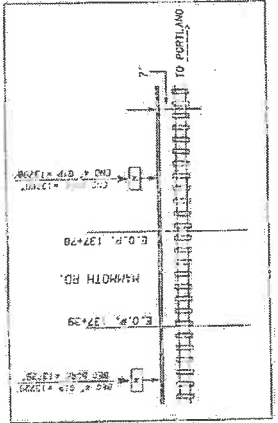

DETAIL '1011'

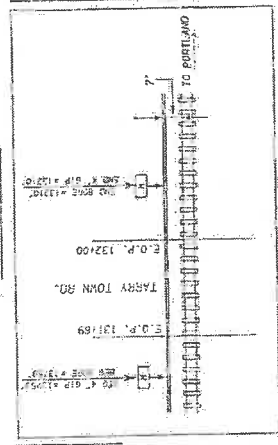

NO.	DESCRIPTION	QUANTITY	UNIT

AS-BUILT NOTES:
 GENERALLY PLACED AT 42" DEPTH, UNLESS NOTED.
 ALL 4" CONDUIT HAS A 1 1/4" JACKET.

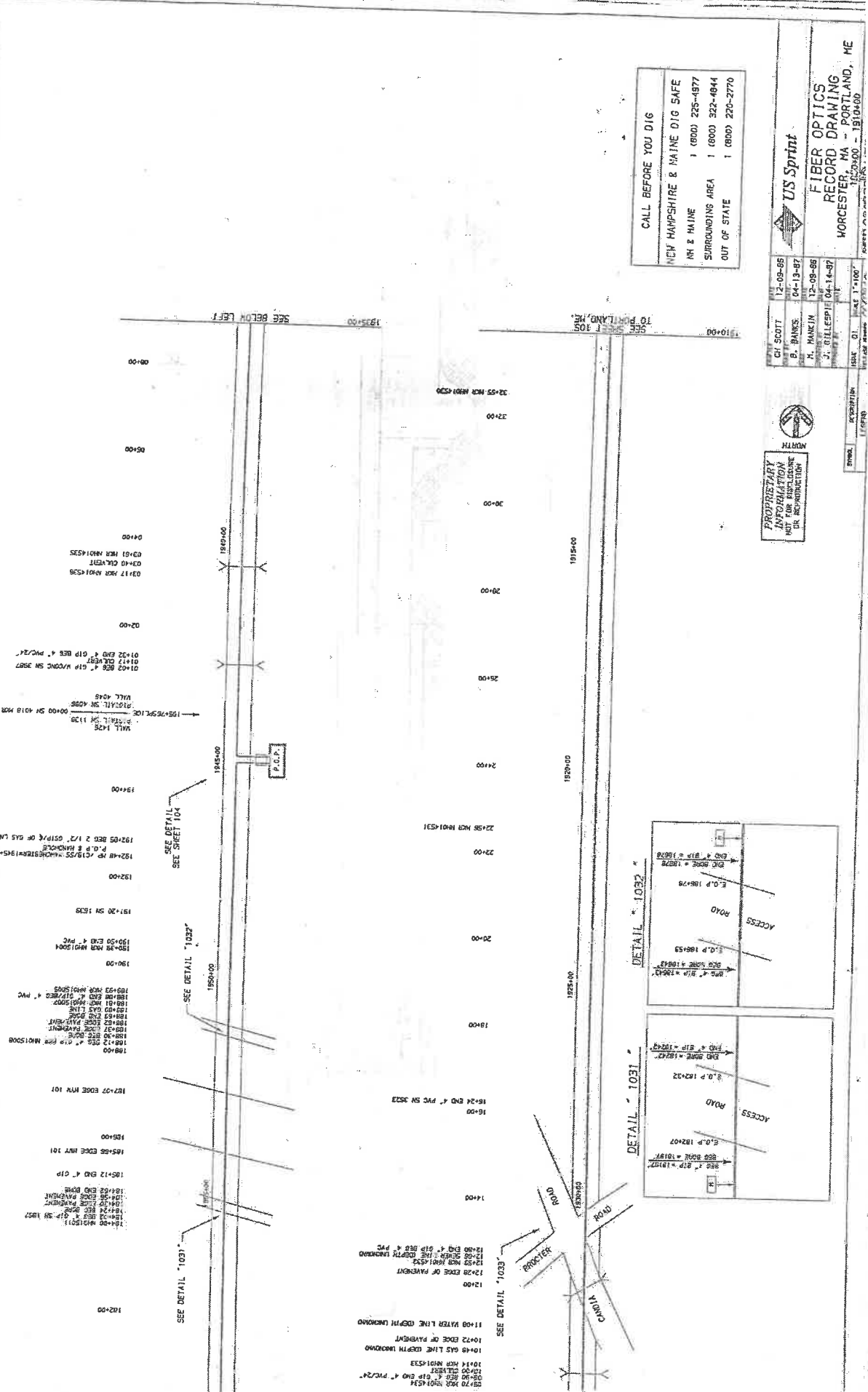

CALL BEFORE YOU DIG
 NEW HAMPSHIRE & MAINE DIG SAFE
 NH & MAINE 1 (800) 225-4877
 SURROUNDING AREA 1 (800) 322-4844
 OUT OF STATE 1 (800) 220-2770

US Sprint
 FIBER OPTICS
 RECORD DRAWING
 WORCESTER, MA - PORTLAND, ME
 1-800-445-4600 - 1-800-445-4600

DATE	BY	DESCRIPTION
12-09-06	G. SCOTT	
04-13-07	B. BARKS	
12-09-06	H. MANVIN	
04-14-07	J. RILLETT	

PROPRIETARY INFORMATION NOT TO BE REPRODUCED OR TRANSMITTED IN ANY FORM OR BY ANY MEANS, ELECTRONIC OR MECHANICAL, INCLUDING PHOTOCOPYING, RECORDING, OR BY ANY INFORMATION STORAGE AND RETRIEVAL SYSTEM.

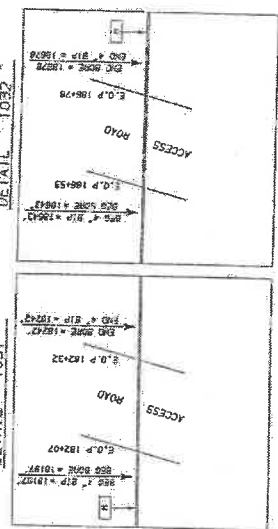

SEE DETAIL '1031'
 SEE DETAIL '1032'
 SEE DETAIL '1033'
 SEE DETAIL '1034'

102+00
 104+00
 106+00
 108+00
 110+00
 112+00
 114+00
 116+00
 118+00
 120+00
 122+00
 124+00
 126+00
 128+00
 130+00
 132+00
 134+00
 136+00
 138+00
 140+00
 142+00
 144+00
 146+00
 148+00
 150+00
 152+00
 154+00
 156+00
 158+00
 160+00
 162+00
 164+00
 166+00
 168+00
 170+00
 172+00
 174+00
 176+00
 178+00
 180+00
 182+00
 184+00
 186+00
 188+00
 190+00
 192+00
 194+00
 196+00
 197+00

102+00
 104+00
 106+00
 108+00
 110+00
 112+00
 114+00
 116+00
 118+00
 120+00
 122+00
 124+00
 126+00
 128+00
 130+00
 132+00
 134+00
 136+00
 138+00
 140+00
 142+00
 144+00
 146+00
 148+00
 150+00
 152+00
 154+00
 156+00
 158+00
 160+00
 162+00
 164+00
 166+00
 168+00
 170+00
 172+00
 174+00
 176+00
 178+00
 180+00
 182+00
 184+00
 186+00
 188+00
 190+00
 192+00
 194+00
 196+00
 197+00

102+00
 104+00
 106+00
 108+00
 110+00
 112+00
 114+00
 116+00
 118+00
 120+00
 122+00
 124+00
 126+00
 128+00
 130+00
 132+00
 134+00
 136+00
 138+00
 140+00
 142+00
 144+00
 146+00
 148+00
 150+00
 152+00
 154+00
 156+00
 158+00
 160+00
 162+00
 164+00
 166+00
 168+00
 170+00
 172+00
 174+00
 176+00
 178+00
 180+00
 182+00
 184+00
 186+00
 188+00
 190+00
 192+00
 194+00
 196+00
 197+00

102+00
 104+00
 106+00
 108+00
 110+00
 112+00
 114+00
 116+00
 118+00
 120+00
 122+00
 124+00
 126+00
 128+00
 130+00
 132+00
 134+00
 136+00
 138+00
 140+00
 142+00
 144+00
 146+00
 148+00
 150+00
 152+00
 154+00
 156+00
 158+00
 160+00
 162+00
 164+00
 166+00
 168+00
 170+00
 172+00
 174+00
 176+00
 178+00
 180+00
 182+00
 184+00
 186+00
 188+00
 190+00
 192+00
 194+00
 196+00
 197+00

102+00
 104+00
 106+00
 108+00
 110+00
 112+00
 114+00
 116+00
 118+00
 120+00
 122+00
 124+00
 126+00
 128+00
 130+00
 132+00
 134+00
 136+00
 138+00
 140+00
 142+00
 144+00
 146+00
 148+00
 150+00
 152+00
 154+00
 156+00
 158+00
 160+00
 162+00
 164+00
 166+00
 168+00
 170+00
 172+00
 174+00
 176+00
 178+00
 180+00
 182+00
 184+00
 186+00
 188+00
 190+00
 192+00
 194+00
 196+00
 197+00

102+00
 104+00
 106+00
 108+00
 110+00
 112+00
 114+00
 116+00
 118+00
 120+00
 122+00
 124+00
 126+00
 128+00
 130+00
 132+00
 134+00
 136+00
 138+00
 140+00
 142+00
 144+00
 146+00
 148+00
 150+00
 152+00
 154+00
 156+00
 158+00
 160+00
 162+00
 164+00
 166+00
 168+00
 170+00
 172+00
 174+00
 176+00
 178+00
 180+00
 182+00
 184+00
 186+00
 188+00
 190+00
 192+00
 194+00
 196+00
 197+00

